



Separate Drive Rotary Vane

11.5 cfm at 1440 rpm, 14.5 cfm at 1725 rpm



Vacuum Pump



Compressor

Oiless 1550 Series

MODEL 1550 SERIES

20" HG MAX. VAC., 14.5 CFM OPEN FLOW

15 PSI MAX. PRESSURE

PRODUCT FEATURES

- Oilless operation
- Pulley driven (multiple speeds possible)
- Rugged construction/low maintenance
- Essentially pulse-free service

INCLUDES (on Standard Models)

- Filter AB600F (Vacuum Pump)/AC433 (Compressor)
- Muffler AB600J (Vacuum Pump)
- Cooling fan AC326C
- 5" P.D. pulley AB140

RECOMMENDED ACCESSORIES

- Base AB897A (Vacuum Pump)/AB889A (Compressor)
- Belt guard AB332A (Vacuum Pump)/AB334B (Compressor)
- Vacuum relief valve AA840A
- Pressure relief valve AA600
- Vacuum gauge AA640
- Pressure gauge AA644B
- Repair kit K231A (use 2 for 1550-184-T337)

Product Dimensions (mm, inches)

Dimensions are for reference only.

Vacuum Pump

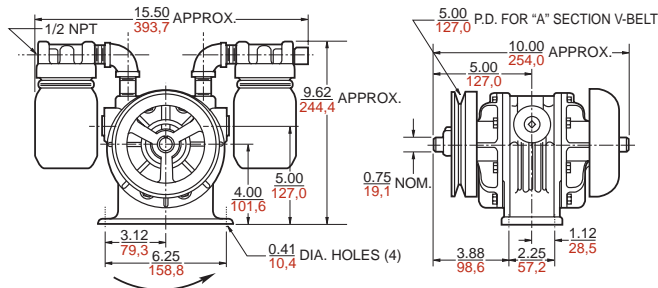

Compressor

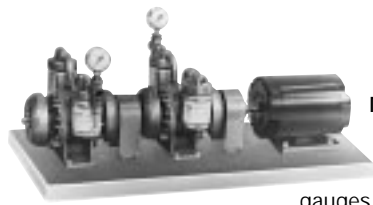
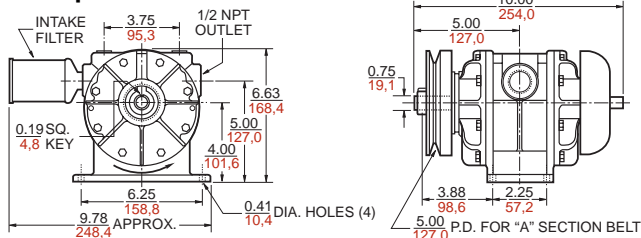

Model 1550-184-T337 is especially suited for Graphic Arts applications. It includes a 1550 vacuum pump and compressor on a base, with motor, gauges, and relief valves – see specifications below.

Performance for each pump is shown on the chart to the right.

L – 35" (889,0 mm), W – 19.5" (495,3 mm), H – 15" (381,0 mm)

Product Performance (Metric, U.S.)

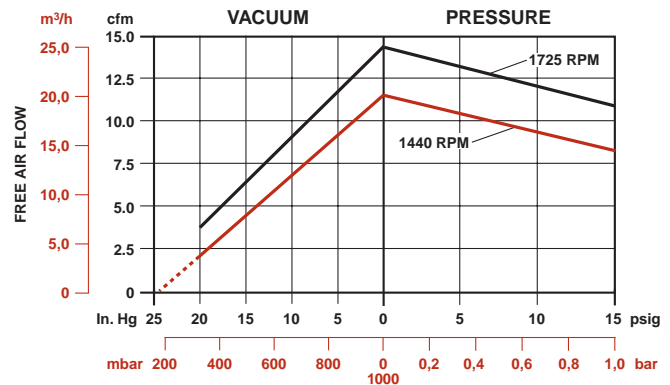

Product Specifications

Note: "P" models are pressure, "V" models are vacuum.

Model Number	Motor	Belt Guard	Base	Thermotector	RPM	HP	kW	Net Wt.	
								lbs.	kg
1550-P139B	—	—	—	—	1440	1	0,75	30	13,5
1550-P140J	—	•	•	—	1725	1½	1,1	57	25,7
1550-141J-T336 (P)	230/460-60-3	•	•	—	1725	1½	1,1	89	40,1
1550-P139B-SD110-1*	220/240-380/415-50-3 IP54	•	•	—	1725	1½	1,1	89	40,1
1550-V136B	—	—	—	—	1725	¾	0,56	33	14,9
1550-V137J	—	•	•	—	1440	½	0,37	52	23,4
1550-V138K-G34AX	115/230-60-1	•	•	•	1440	½	0,37	76	34,2
1550-V137K	—	•	•	—	1725	¾	0,56	52	23,4
1550-V138L-G38AX	115/230-60-1	•	•	•	1725	¾	0,56	80	36,0
1550-V136B-SD100-1*	380/415-50-3	•	•	—	1725	1	0,75	80	36,0
1550-184-T337**	208-230/460-60-3	•	•	—	1725	2	1,5	139	62,6

*Available only in Europe.

**Graphic Arts model – dual pumps on a base, with motor.