



R6P SERIES

MODELS R6P335A, R6P350A, R6P350B, R6P355A

MAXIMUM PRESSURE, VACUUM AND AIR FLOW VARIES FOR THE R6P SERIES, DEPENDING ON THE MODEL(S). REFERENCE THE CHART FOR THE SPECIFIC MODEL PERFORMANCE

PRODUCT FEATURES

- Rugged construction, low maintenance
- Oilless operation
- UL and CSA approved TEFC motors with permanently sealed ball bearings
- Aluminum cover, impeller and housing
- Inlet and outlet have internal muffling

RECOMMENDED ACCESSORIES

- Pressure gauge AE133
- Inlet filter AJ126F (pressure)
- Vacuum gauge AE134
- Inline filter AJ151G (vacuum)
- Muffler AJ121F
- Relief valve AG258
- Liquid separator RMS300 (vacuum)
- Foam replacement kit K907

MODELS	Maximum Pressure ("H ₂ O)		Maximum Vacuum ("H ₂ O)		Maximum Air Flow (CFM)	
	60 Hz	50 Hz	60 Hz	50 Hz	60 Hz	50 Hz
R6P335A	30	50	35	60	265	230
R6P350A R6P350B	60	70	70	70	290	245
R6P355A	110	85	90	70	265	225

Product Dimensions (in. mm)

Note: Unit must be mounted horizontally, foot pad down

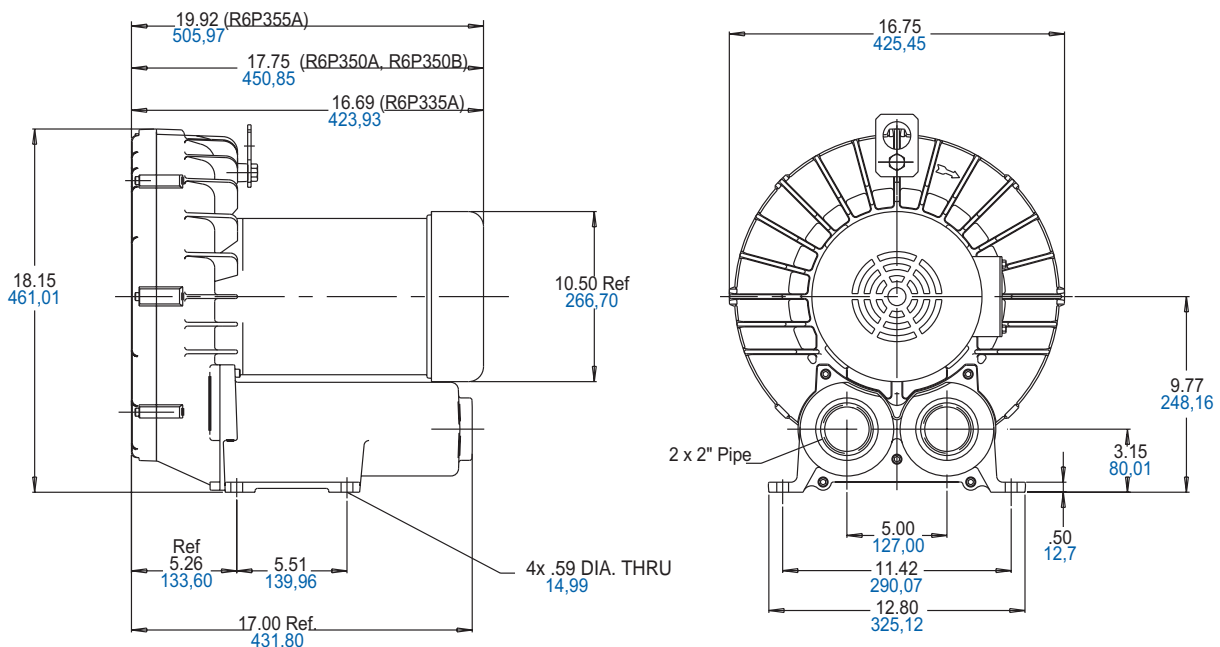



Product Specifications

MODEL NUMBER		R6P335A	R6P350A	R6P350B	R6P355A
Motor Enclosure		TEFC	TEFC	TEFC	TEFC
HP/kW	60 Hz	3.5/2,6	5.0/3,7	5.0/3,7	5.5/4,1
	50 Hz	2.5/1,9	4.8/3,6	-	5.0/3,7
Voltage	60 Hz	208-230/460-3	208-230/460-3	575-3	208-230/460-3
	50 Hz	190-220/380-415-3	190-220/380-415-3	-	190-220/380-415-3
Amps	60 Hz	9.7-8.8/4.4	13.0-12.0/6.0	4.8	19.5-18.2/9.1
	50 Hz	8-8/4-3.9	14.4-13.4/7.2-6.8	-	14.2-13.4/7.1
Starting Amps	60 Hz	50 @ 460V	125 @ 230V	35 @ 575V	83 @ 460V
	50 Hz	40.5 @ 380V	57 @ 380V	-	72 @ 380V
Insulation Class		F	F	F	F
Recommended NEMA Starter Size		1/0	1/0	0	1/0
Net Weight (lbs/kg)		150/68	176/80	176/80	215/98

Product Performance

Model R6P335A

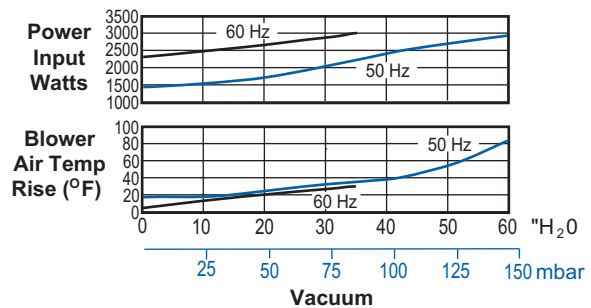
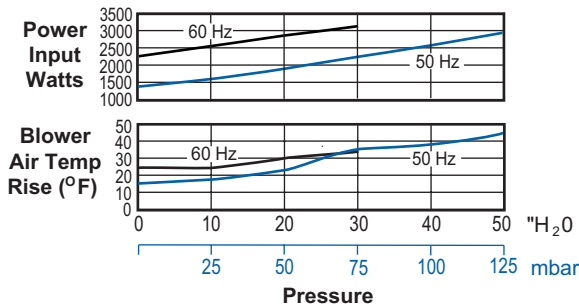
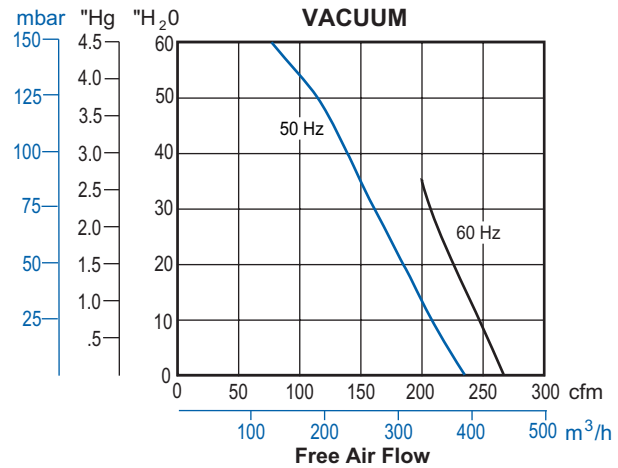
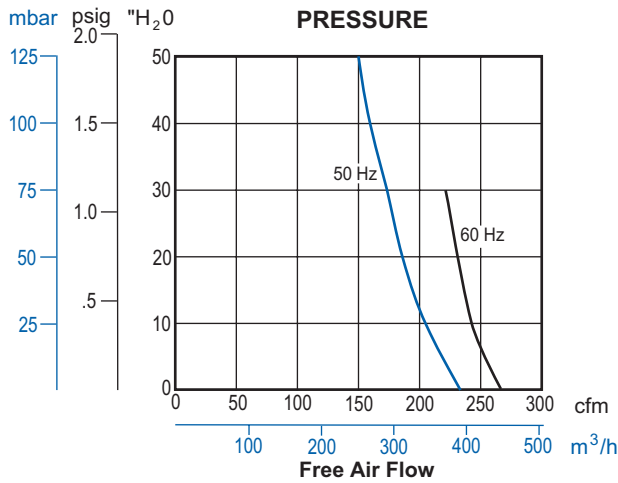



Product Performance

Models R6P350A, R6P350B

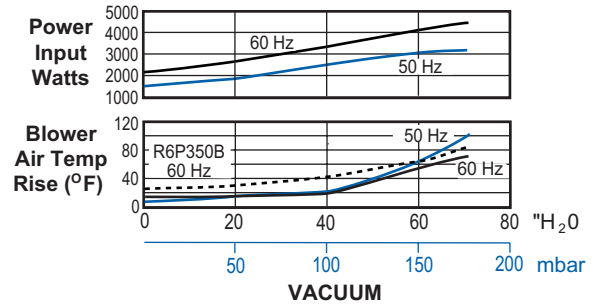
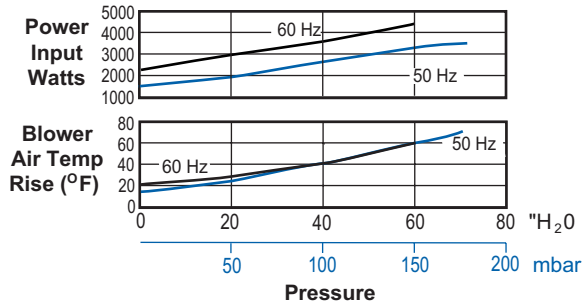
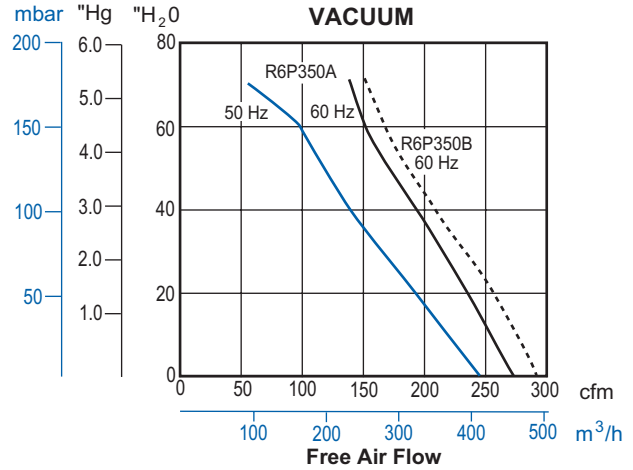
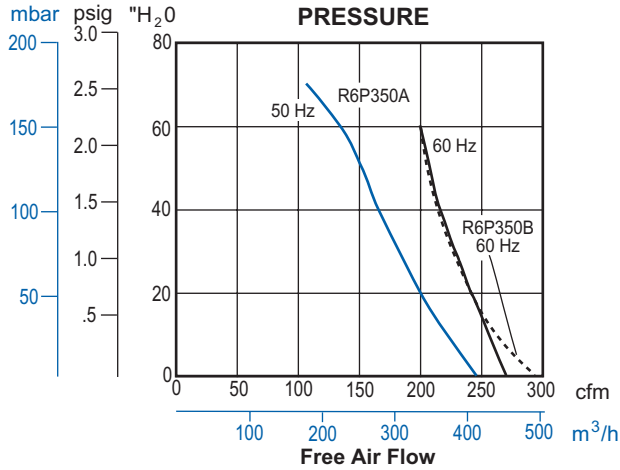

Product Performance

Model R6P355A

