

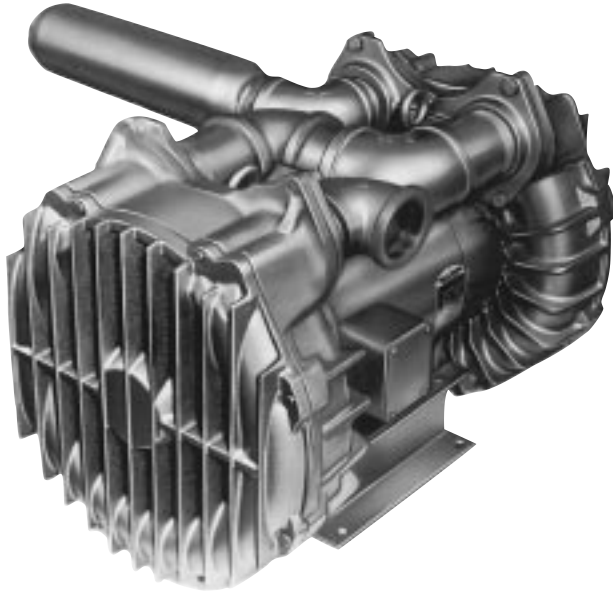

High Pressure Models



R9S SERIES MODEL R9S3300M

MAX. PRESSURE – 222" H₂O (60 Hz), 208" H₂O (50 Hz)

MAX. VACUUM – 149" H₂O (60 Hz), 142" H₂O (50 Hz)

MAX. AIR FLOW – 660 CFM (60 Hz), 585 CFM (50 Hz)

PRODUCT FEATURES

- Rugged construction, low maintenance
- Oilless operation
- UL and CSA approved motor with permanently sealed ball bearings
- Cast iron housing, cover and muffler enclosure.
- Cast aluminum impeller
- External muffler for additional silencing AJ121H
- Smaller and less costly than two motor-mounted units

RECOMMENDED ACCESSORIES

- Pressure gauge AE133F
- Inlet filter AJ126M (pressure)
- Vacuum gauge AE134
- Vacuum gauge for monitoring inlet filter restriction AJ497
- Pressure/vacuum relief valve AG258F
- Silencer for vacuum relief valve AJ121G
- Inline filter AJ151M (vacuum)

Product Dimensions (in. mm)

Note: Unit must be mounted with shaft horizontal

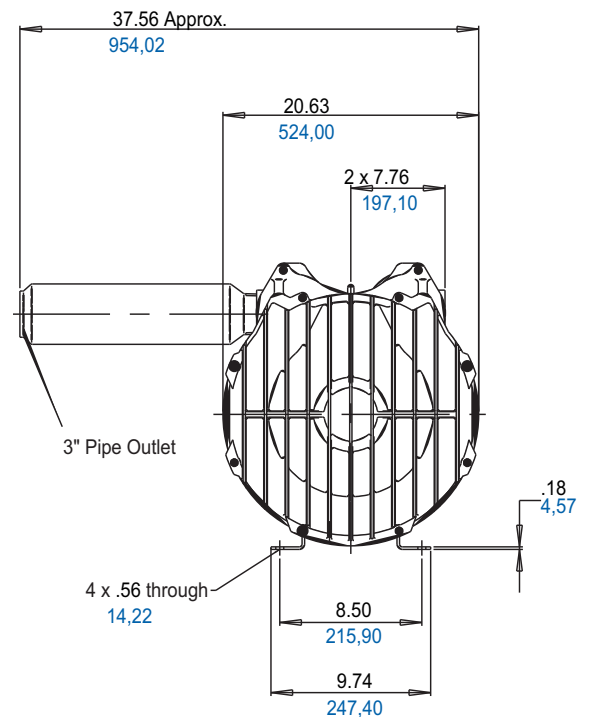
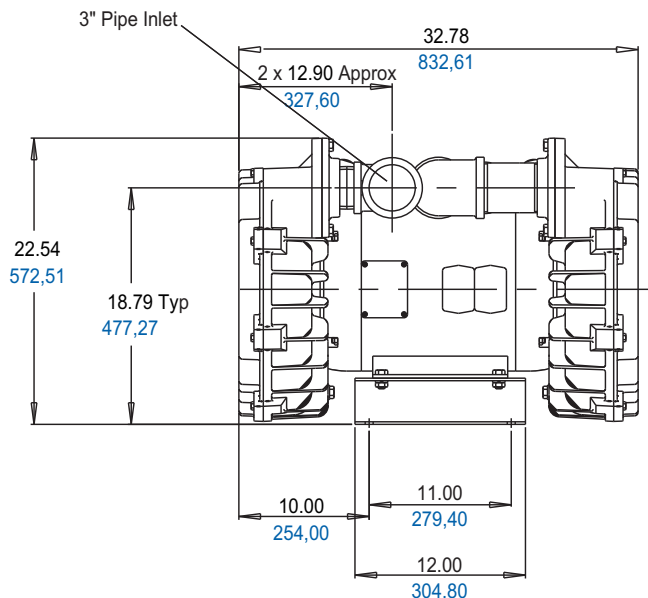



Product Specifications

MODEL NUMBER		R9S3300M
Motor Enclosure		ODP
HP/kW	60 Hz	30/22,3
	50 Hz	19/14,3
Voltage	60 Hz	230/460-3
	50 Hz	190-220/380-440-3
Amps	60 Hz	98/49
	50 Hz	82-47/41-39
Starting Amps	60 Hz	320 @ 460V
	50 Hz	308 @ 440V
Insulation Class		F
Recommended NEMA Starter Size		3/3
Net Weight (lbs/kg)		606,275

Product Performance

